

**Homes by
Josh Doyle**

The Sanctuary

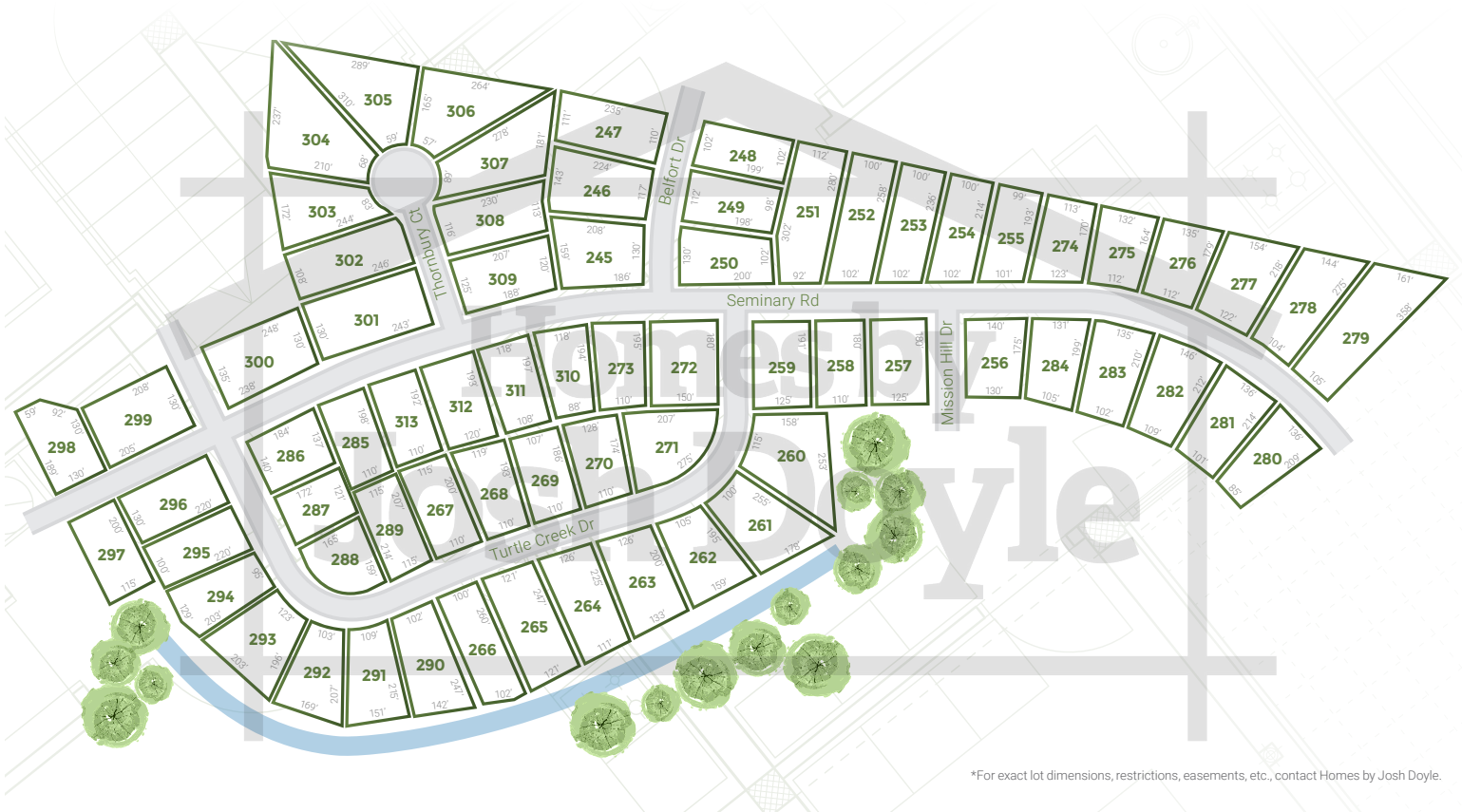

*For exact lot dimensions, restrictions, easements, etc., contact Homes by Josh Doyle.

THE SANCTUARY

The Sanctuary is 373 acres of divine living, offering lots in many price ranges to host limitless sized homes. The Sanctuary is a breath of fresh air, surrounded by nature's best. It's far enough away from it all, but close to everything Perrysburg has to offer. Discover what life at The Sanctuary has to offer you in their many communities: Sanctuary, Sanctuary in the Woods, Sanctuary on the River, Sanctuary Meadows, and Sanctuary in the Abby. Stop into one of our model homes to reserve your lot today!

**Call Homes by Josh Doyle or visit
HomesbyJoshDoyle.com for the latest lot availability!**



The **OMAHA** (spec home)

This is a sample of the homes built or that will be built in The Sanctuary. **Call Homes by Josh Doyle** or **visit HomesbyJoshDoyle.com** for the latest on lot availability, pricing, and to schedule an appointment to **design your home for FREE in 3D with Josh.**



The **DENVER**



The **NEVADA**



The **COLORADO**



The **MONTANA**



The **OAK HARBOR**



The **NANTUCKET**

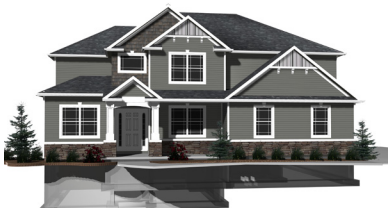

The **METAMORA**



The **BOMBAY**



The **WASHINGTON**



HomesByJoshDoyle.com | 419.705.1091
10075 Waterville St. | Whitehouse, OH



© JA Doyle LLC